

## Tube cutting and bevelling machines type PROTEM® TTS-NG

### Technical Features

Machining and clamping capacity	<b>10,3 mm OD – 219 mm OD</b> <b>1/8" – 8" OD</b>
Clamping Feed	<b>Manual with key</b> <b>Automatic with clutch</b>

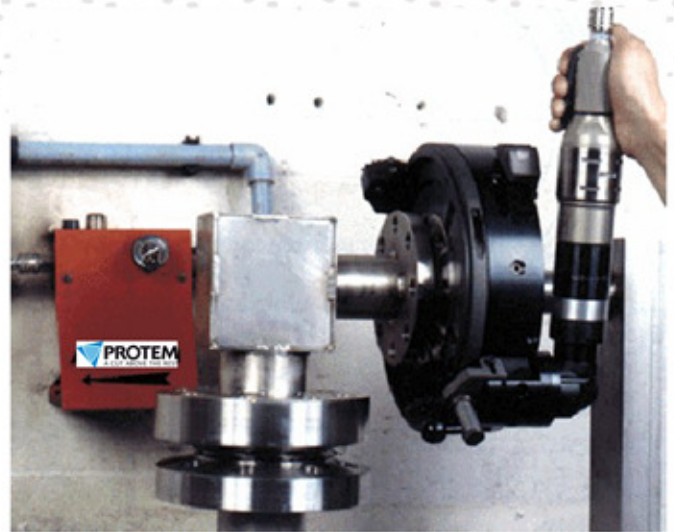

*No heat affected zone!*

The **TTS-NG-Series** allow accurate cutting and/or bevelling of tubes and pipes of all schedules from 10,3 mm up to 273 mm OD in one simultaneous operation. Their reduced weights and overall dimensions enable these machines to work where there is a shortage of space.

The special design of the machines shows in the following characteristics:

- Split frame configuration: opening in two half-shells
- Manual clamping using 4 independent adjustable jaws
- Rear centering feature

#### Machine is delivered with:

- Clamping jaws
- 1 pointed cutting tool bit
- 1 severing cutting tool bit
- Keys, screws
- Operating manual

#### Optional equipment:

- Right-angle drive
- Electric drive
- Special tool holder for inside beveling work

Subject to modification without prior notice. Its content is confidential, this document is unique and is PROTEM property, it shall not be corrected, duplicated or modified without the written agreement of PROTEM. The content refers exclusively to the sales and delivery conditions of the seller.

Page 1 / 2

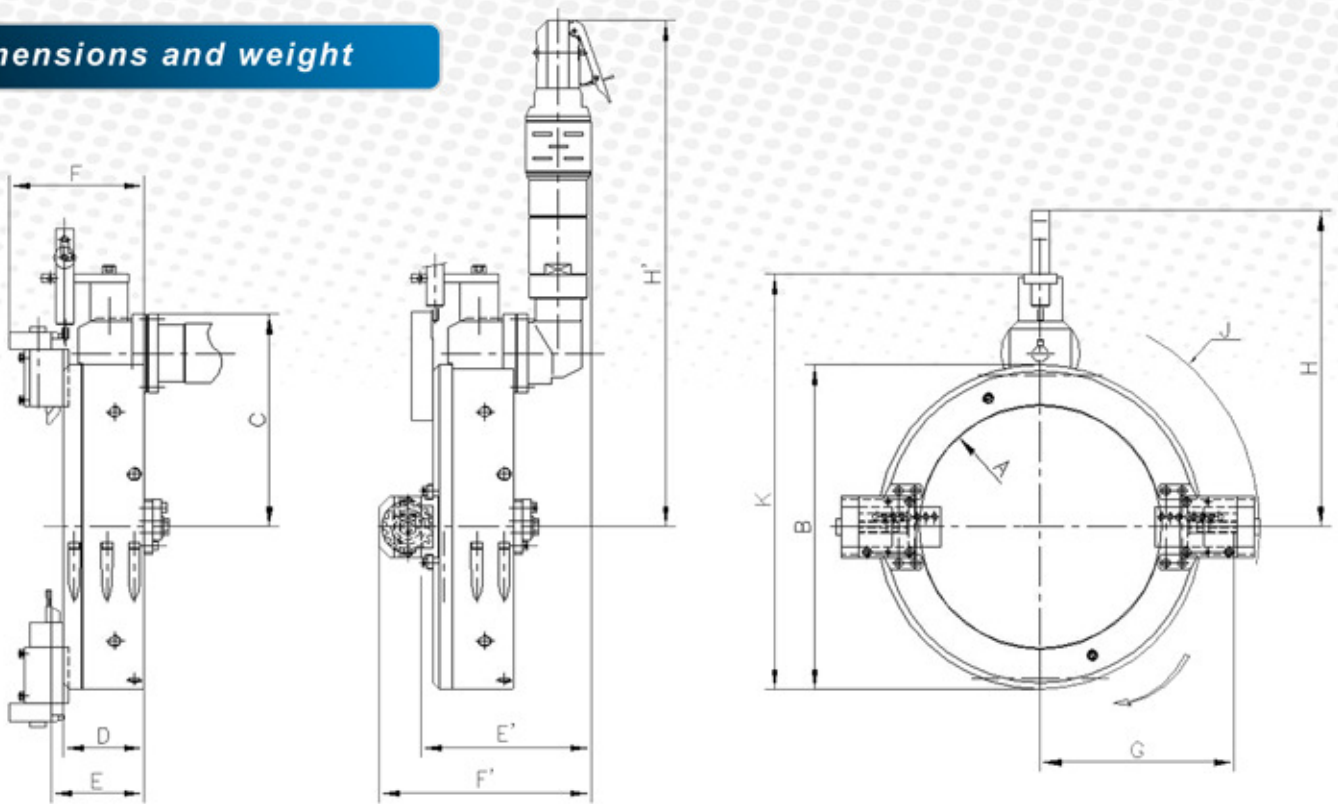
**Dimensions and weight**

Model	Capacity	ØA mm	ØB mm	ØC mm	ØD mm	ØG mm	ØJ mm	Weight approx.	E mm	F mm	H mm	E' mm	F' mm	H' mm
TTS-NG27	1/8"-3/4" 10,3 - 26,7	30	106	100	86	81,5	175	3,5 kg	97,5	135,5	175,5	156	194	368,5
TTS-NG33	1/8"-1" 10,3 - 33,4	36	112	103	86	84,5	181	4 kg	97,5	135,5	178,5	156	194	371,5
TTS-NG42	1/8"-1"1/4" 10,3 - 42,2	45	121	107,5	74	89	187	4,5 kg	85,5	123,5	183,5	156	194	376
TTS-NG48	1/8"-1"1/2" 10,3 - 48,3	51	127	110,5	74	92	194	5 kg	85,5	123,5	186,5	156	194	379
TTS-NG60	1/2"-2" 21,3 - 60,3	63	139	116,5	74	98	206	5,3 kg	85,5	123,5	192,5	156	194	385
TTS-NG73	1/2"-2"1/2" 21,3 - 73,0	75	151	122,5	74	104	223,5	5,5 kg	86,5	123,5	198,5	156	194	391
TTS-NG88	1"-3" 33,4 - 88,9	90	166	130	74	111,5	232,5	6 kg	85,5	123,5	205,5	156	194	412
TTS-NG101	1"1/2-3"1/2" 48,3 - 101,6	105	181	137,5	74	119	250,5	6,5 kg	85,5	123,5	213	156	194	406
TTS-NG114	2"-4" 60,3 - 114,3	117	193	143,5	74	125	259,5	7 kg	85,5	123,5	219	156	194	412
TTS-NG127	2"-4"1/2" 60,3 - 127,0	129	205	149,5	74	131	271,5	7,5 kg	85,5	123,5	225	156	194	418
TTS-NG141	2"1/2-5" 73,0 - 141,3	144	220	157	74	138,5	286,5	8,5 kg	85,5	123,5	232,5	156	194	425,5
TTS-NG168	3"-6" 88,9 - 168,3	171	247	170,5	74	152	351,5	10 kg	85,5	123,5	265,5	156	194	439
TTS-NG193	4"-7" 114,3 - 193	195	271	182,5	74	164	375,5	11 kg	85,5	123,5	277,5	156	194	451
TTS-NG219	5"-8" 141,3-219,1	222	298	196	74	177,5	402,5	12 kg	85,5	123,5	291	156	194	464,5